

# Ties that Bind: An Integrative Approach to Child Welfare

Friday, April 17, 2009



Clark Kerr Conference Center  
University of California, Berkeley

## Welcome from the Student Day Coordinator

---

Greetings,

I am Susan Alfaro, this year's Student Day Coordinator. I would like to welcome and thank you all for being here today. The theme for this year's Student Day conference is *"The Ties that Bind: An Integrative Approach to Child Welfare."*

Today at Student Day, we have an amazing group of people, some of whom you may be familiar with and others whom you have yet to meet. What I ask of you today is to share your experiences and develop brand new connections with your colleagues. As a whole, we must come together, step out of our comfort zones, to engage in dialogue and produce an enriching collaboration. We must communicate, join forces, and make change for the betterment of the child welfare system. As social workers, we must provide support in order to have more effective outcomes for the families and children we will be working with. We are here to gain as much awareness and knowledge as possible from this conference, and I hope that you take advantage of this opportunity.

I would like to send a special thank you to all the Title IV-E Student Representatives from the 19 universities in California who made Student Day 2009 possible. With all their hard work and dedication, we have arrived at this day and are in store for a wonderful event.

Susan Alfaro  
*Student Day Coordinator*  
*San Francisco State University*  
*Masters of Social Work Candidate, 2009*



*The Title IV-E Student Day Conference is funded by the California Social Work Education Center (CalSWEC), through a contract with the California Department of Social Services. CalSWEC is the nation's largest coalition of social work educators and practitioners.*



*Partial funding provided by the California Department of Social Services.*

**Student Day 2008-2009 Planning Committees**

<b>Exhibitor</b>	<b>Fundraising</b>	<b>Media</b>	<b>Registration</b>	<b>Workshop</b>
Kristin Flores	Winona Aubrey	Susana Elias	Janet Armenta	Monica Aguilar
Amanda Hernandez	Angelita Casares-Saenz	Sherrill Elson	Omar Banda	Michele Bechard
Shamont Hussey	Laura Knoblock	Laura Gomez	Kimberly Davis	Deanna Bernard
Davine Jackson	Nicole Lock	Carol Hernandez	Stacy Kahn	Cerelia Bragg
Dionne Puckett	Ethan Michaels	Raul Lopez	Danielle Libby	Jennifer Brown
	Georgina Robinson	Yvette Lopez	Lenwood Paterson	Stephanie Cape
	Fernando Santoyo	Katie Maresca	David Slotterbeck	Muhammad Elbgal
	Genever Thomas	Ann Mudie	Margret Vallejo	Denise D. Garcia
		Justian O’Ryan	Jayne Weir	Janine Garrett
		Edgar Powe	Natasha Wilson	Terri Jenkins
		Michele Stayer		Jennifer Kadas
		Raha Tabankia		Amy Klang
				Marissa Mecir
				Andrea Nava
				Jennifer Payne
				Shauntina Sorrells
				Katrina Tattenham

## Student Day 2009 Conference Schedule

---

8:00 a.m.: Registration and Continental Breakfast

8:30 a.m.—*Joseph Wood Krutch Theatre*

Welcome and Introduction:

Susan Alfaro, *Student Day 2009 Coordinator*

Barrett Johnson, LCSW, *Director, Child Welfare In-Service Training Project, CalSWEC*

Janlee Wong, MSW, *Executive Director, NASW, California Chapter*

8:50 a.m.

Guest Speaker: Linné Stout, *Chief, Child Protective and Family Support Branch, California Department of Social Services*

9:15–10:00 a.m.

Keynote Speaker: Supervising Judge Judge Katherine Lucero, *Juvenile Dependency Court, Santa Clara County*

10:10–11:10 a.m.: Workshop Session #1

- |                                    |          |
|------------------------------------|----------|
| 1. Juvenile Dependency Court       | Room 102 |
| 2. Child and Adolescent Psychiatry | Room 104 |
| 3. Thunder Road                    | Room 203 |
| 4. Wraparound                      | Room 204 |

11:20 a.m.–12:20 p.m.: Workshop Session #2

- |   |          |
|---|----------|
| 1. Incarcerated Parents                 | Room 102 |
| 2. Child and Adolescent Psychiatry      | Room 104 |
| 3. Forensic Interviewing (Sexual Abuse) | Room 203 |
| 4. Wraparound                           | Room 204 |

*In 1983, the U.S. Senate and House of Representatives made a commitment to increase awareness of child abuse and neglect by designating April as National Child Abuse Prevention Month*

*In 1989, the Blue Ribbon Campaign to Prevent Child Abuse began as a grandmother's tribute to her grandson, who had died as a result of being abused. She attached a blue ribbon to her car in remembrance of him and to remind her community about the tragedy of child abuse.*

12:30–1:30 p.m.  
Lunch—*Clark Kerr Dining*

1:40–2:40 p.m.: Workshop Session #3

- |   |                               |
|---|-------------------------------|
| 1. Joint Response                       | Room 102                      |
| 2. Disproportionality                   | Room 104                      |
| 3. Forensic Interviewing (Sexual Abuse) | Room 203                      |
| 4. Immigration                          | Room 204                      |
| 5. Parent Partners                      | Joseph Wood<br>Krutch Theatre |

2:50–3:50 p.m.—*Joseph Wood Krutch Theatre*  
ILP Youth Panel

3:50 p.m.  
Closing—Announcement of 2010 Student Day Coordinator

4:00 p.m.  
Reception

---

## **NASW, California Chapter, Executive Director Janlee Wong**

Janlee Wong is the Executive Director of the 12,000-member California Chapter of the National Association of Social Workers (NASW). With over 150,000 members in the United States, NASW promotes, develops, and protects the practice of social work and social workers. It also seeks to enhance the effective functioning and well-being of individuals, families, and communities through its work and its advocacy.

Mr. Wong recently served on the Board of Directors for the Council on Social Work Education. He currently serves on the Board of Directors for the California Social Work Education Center, on the UC Berkeley School of Social Welfare Community Advisory Board, and on the NASW Presidential Initiative on Diversity. Prior to NASW, Mr. Wong was formerly in the San Diego County Chief Administrative Office, where he assisted in the development of collaborative and integrated services and programs for children and families. He also served as the Public Conservator and Chief of Adult Protective Services in San Diego. Mr. Wong has been a healthcare consultant and a budget examiner for the U.S. Office of Management and Budget in Washington, D.C.

Mr. Wong received his MSW from San Francisco State University and a BA in Asian Studies from Claremont McKenna College.

---

## **Guest Speaker: Linné Stout**

Linné Stout is Chief of the Child Protection and Family Support Branch in the California Department of Social Services, where she has worked for 25 years.

Today she will speak on the topic of the Child and Family Service Reviews Program Improvement plan (PIP) for California.

---

---

---

## Keynote Speaker: Judge Katherine Lucero

Judge Katherine Lucero currently sits as Supervising Judge in Juvenile Dependency Court where she oversees hundreds of cases involving abused and neglected children. In 2006, she also sat as an Appellate Judge in the Superior Court Appellate Division. Prior to this assignment, she spent 18 months in both Juvenile Delinquency and Adult Criminal Court. Prior to the criminal court tour she sat from January 2002 through January 2005 in Family Court. Judge Lucero began her judicial career as a Dependency Court Commissioner where she spent her first two years on the bench in Dependency Court.

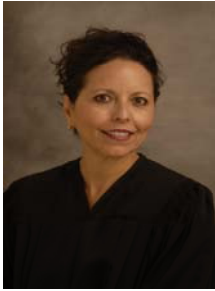

Before being appointed by the Governor in August of 2001, Judge Lucero had spent her entire legal career in the area of child abuse and neglect. She is a former Deputy District Attorney, specializing in crimes against children and the elderly. As a Juvenile Dependency Superior Court Commissioner, she managed approximately 1100 cases involving child abuse and neglect from December 1999 until January

2001.

Six months after she was appointed as a Superior Court Judge she was transferred to Family Court, where she supervised approximately 1,100 cases involving dissolution, custody, visitation, child and spousal support, property division, and domestic violence issues.

In 2002, she started a Family Treatment Court to assist parents with substance abuse problems that had interfered with custody or visitation of their children. In Delinquency Court, Judge Lucero began a series of meetings to promote gender specific programming for girls in the Juvenile Justice System and she also supervised the Juvenile Drug Treatment Court. In Dependency Court, she initiated the thriving South County Dependency Court calendar and the Family Wellness Court for drug-exposed infants and toddlers, and established the innovative Girls Court, which is currently expanding into a Teen Court to include high-risk teen boys.

Judge Lucero has served for the last 18 years on numerous committees, panels, boards, councils, and projects on behalf of the community. She served as a member of the Santa Clara Child Abuse Council for seven years and on the Santa Clara County Child Death Review Team for three years prior to becoming a Commissioner. She has also served as president, vice-president, and treasurer for the Santa Clara County La Raza Lawyers Association. Judge Lucero has also served on various committees for the local bar association including the Judiciary Committee in 1996.

Judge Lucero has trained other judges and child welfare professionals at local, state, and national conferences on issues involving the Impact of Domestic Violence on Children, on Family Drug Courts, on Immigration Issues in Dependency Court, and on the Disproportionate Impact of the Child Welfare System on Children of Color.

## Workshop Descriptions and Presenters

---

### Child and Adolescent Psychiatry

Pediatric/adolescent psychiatry deals with prevention, diagnosis, and treatment of mental illness in children and adolescents. A psychiatrist diagnoses and treats those with mental and emotional concerns such as behavioral issues, child abuse, trauma, disaster recovery, and medication issues. After assessment, the psychiatrist can diagnose, treat, and manage an illness or problem by medication or psychotherapy. COME WITH ALL YOUR QUESTIONS READY FOR THE DOCTOR. DON'T BE AFRAID TO ASK ANYTHING!

#### Presenter

**Dr. Justin Grey** is a child and adolescent psychiatrist with over 19 years of experience in the field. He has both a private practice and works at a non-profit organization that specializes in care for both foster and non-foster youth.

---

### Contra Costa County Independent Living Skills Program

When an adolescent who has been in dependency transitions into adulthood, he or she does not always have adequate preparation to assume the responsibilities and tasks that adulthood requires. Without coaching and assistance in such essential tasks as applying to college, finding work, obtaining a place to live, and even balancing a checkbook, many young transitioning youth have a very challenging path into adult life. Independent Living Skills (ILP) programs are designed to give youth the assistance they need.

#### Presenters

**Don Graves** has extensive experience and a strong commitment working with young adults' transitioning out of the foster care system. He has worked for the Contra Costa County Independent Living Skills Program since April of 1996. He began working as the Cross-Cultural Outreach Specialist and became the Program Coordinator in July 1998, when the program experienced its greatest expansion. He has been a California Youth Connection (CYC) supporter since 1996, and he believes in its mission to promote the participation of foster youth in policy development and legislative change to improve the foster care system. Prior to working for Contra Costa County ILSP, Mr. Graves worked 3 1/2 years for Bay Area Youth Homes Inc., an agency providing group home care to foster youth ages 8–18. He served as group home counselor, facility manager, and finally field supervisor.

Mr. Graves received a BA in Sociology from the University of Montana in 1992 after transferring from Chabot Community College in Hayward on a full football scholarship. He was born in Oakland and is a lifetime resident of the East Bay.

**Two graduates of the ILP program** will be sharing their successful experience with ILP.

---

### Disproportionality: Racial Disproportionality and Disparity in California's Child Welfare System

In California and the nation as a whole, there are significant differences in the rates at which children of color have contact with the child welfare system, particularly African American and Native American children. This presentation will look more closely at racial disproportionality and disparity using administrative data from California's Child Welfare Services/Case Management System. Racial disproportionality and disparity will be examined by considering what defines disproportionality and disparity, who is disproportionately represented, where disproportionality is observed, when disparities arise, why disparities exist, and how disproportionality is being addressed in California.

**Presenter**

**Emily Putnam-Hornstein** is a doctoral candidate in the School of Social Welfare at UC Berkeley with a focus on quantitative methodology, child abuse and neglect, and family well-being. She has nearly four years of experience working with longitudinal, administrative child welfare data as a Graduate Student Researcher at the Center for Social Services Research. Prior to entering the doctoral program, Emily received her MSW from Columbia University and her BA in psychology from Yale University.

---

**Forensic Interviewing**

This workshop presents forensic interviewing of children up to 18 years of age. Frequently, the children to be interviewed have experienced sexual abuse, physical abuse or have witnessed violence. The presenter works with a multi-disciplinary team that includes the San Francisco District Attorney's Office, San Francisco Police Department, and San Francisco Human Services Agency.

**Presenter**

**Gloria Samayoa, LCSW, MDIC coordinator**

---

**Immigration**

This workshop will provide an overview of the immigration system, the Department of Homeland Security, and the immigration court and detention system. Recent raids and the rights of non-citizens, as well as the impact on children and families, will be discussed. Participants will also be informed about forms of relief for children and domestic violence victims: U Visas, Violence Against Women Act, asylum, and Special Immigrant Juvenile Status. Time will also be allocated for a question-and-answer period.

**Presenters**

**Carmen Villegas-Grant** graduated from San Francisco State University with an MSW. She has been working with the San Francisco Department of Human Services for 20 years. She was a key person in the creation and implementation of three Bilingual Spanish-Speaking Units and finalizing SFDHS policy in working with Immigrant Families in the Child Protective System.

**Allison Davenport, Esq.**, is the Staff Attorney at Centro Legal de la Raza, a community-based legal aid organization in Oakland's Fruitvale District, where she specializes in immigration and refugee law, specifically family-based immigration, asylum, Violence Against Women Act, U Visas, and removal/deportation defense with a focus on serving domestic violence survivors. She was in private practice as an immigration attorney after graduating from Boalt Hall School of Law at UC Berkeley and is a member of the California State Bar.

---

**Incarcerated Parents: Understanding the Needs of Children in the Child Welfare System whose Parents Are Incarcerated**

Children affected by parental incarceration are clearly woven into the population served by the child welfare system. Given the current growth trends in the inmate population, the number of children in child welfare with an incarcerated parent will continue to increase. Recent research shows that the number of children whose families are involved in both the criminal justice and child welfare systems is much larger than previously believed (1 in 8 children who are reported victims of parental maltreatment also had a parent who was arrested within six months of the report). This workshop will provide an overview of the complex realities of families affected by incarceration and child welfare and provide relevant information for social workers to best serve the needs of this population. The presenters will also

discuss an important and exciting contact visitation model which provides family support and parent education in the San Francisco jail setting.

**Presenters**

**Yali Lincroft, MBA**, is a public policy consultant for the Annie E. Casey Foundation's Family to Family Initiative. Family to Family is a national child welfare and foster care reform initiative located in 25 California counties and 15 states. She maintains a page on the California Department of Social Services' Family to Family website focused on the intersection of child welfare and children of incarcerated parents, <http://www.f2f.ca.gov/Children.htm>, and is currently working on a national toolkit for child welfare staff focused on addressing the needs of this population.

**Roshawn Singleton** is the Friend's Outside incarcerated parents' staff in the San Francisco Jail. Her responsibilities include working with social workers toward reunifying children in dependency with their incarcerated parents. She conducts emergency response interviews, supervises parent/child contact visits, and helps the incarcerated parents with referrals for housing, substance abuse, employment and other services in the San Francisco Jail.

**Kelli Finley** has her Master's in Counseling with an emphasis on Marriage and Family Therapy and has an extensive background working with children, their families, and vulnerable populations. She manages the One Family Program, which seeks to increase the amount and quality of contact visits for children of incarcerated parents in conjunction with the implementation of a state of the art parenting education curriculum called Parenting Inside Out.

---

**Joint Response: Developing a Partnership between Child Protective Services and Law Enforcement at the Time of Arrest**

Research by the California Research Bureau and others has confirmed that children are often overlooked at an arrest scene. In extreme cases, children have been left unsupervised and alone to fend for themselves and their siblings. They are traumatized not only by the parental arrest, but also by the impact of the arrest on their immediate circumstances and long-term care. This workshop will describe the importance of a coordinated response, involving law enforcement and child welfare, as an effective way to ensure that children are kept safe when their parents are arrested. The presenters will provide an overview of the key needs facing children at parent arrest, and how different formal protocols and working agreements with child welfare and law enforcement throughout California have helped address this issue.

**Presenters**

**Ginny Puddefoot, MPP**, is currently the Deputy Director for Health Policy, Legislation, and External Affairs for the Managed Risk Medical Insurance Board. Until recently, she was as a Senior Research and Policy Specialist for the California Research Bureau in the California State Library, a position she held since 1999. She is the primary author of "Keeping Children Safe When Their Parents Are Arrested: Local Approaches That Work" (2007) published by the California Research Bureau. She was the Project Director of the California Homeless Youth Project and Public Policy Program Director for the Foundation Consortium. Ms. Puddefoot received her undergraduate degree from Stanford University and her Master's in Public Policy and Public Health from UC Berkeley.

**Bridgett Ortega, MA, JD**, is currently a consultant for the San Francisco Children of Incarcerated Parents Partnership. She has been a faculty member in the Criminal Justice Department at Axia College, University of Phoenix since 2005 and served as adjunct faculty for Santa Clara Law School, San Jose State University, and Portland State University. Her experience includes co-founding the Santa Clara County Juvenile Treatment Court and serving as a Steering Committee member of the Restorative Justice Project in Santa

Clara. Her research accomplishments include developing a multi-disciplinary curriculum entitled “And How are the Children,” which assists communities in creating safety nets for children of incarcerated parents. In addition, Ms. Ortega had worked as a public defender for Santa Clara County.

---

### **Juvenile Dependency**

Juvenile dependency involves the process by which a child enters the formal child welfare legal system, goes into protective custody, and ultimately moves towards a case dismissal or adoption. This workshop will present the steps in the process by an expert in juvenile dependency who also coaches social workers in how to give court testimony.

#### **Presenter**

**Michael Gammino, LCSW**, has been a LCSW in Santa Clara County for 21 years and has served as the Social Work Supervisor in the Dependency Unit at the District Attorney's Office for 15 years. He is an expert. Come to this workshop to learn more!

---

### **Parent Partners**

Parent Partners are mothers and fathers who successfully navigated their way through the child welfare system and now act as mentors, advocates, and guides for other parents in the same situation. Parent Partners offer support, guidance, and encouragement; explain confusing language and concepts; address questions and concerns; help with accessing services and resources; attend meetings with family members; and facilitate the Navigation Orientation.

#### **Presenters**

**Judi Knittel** is the supervisor of the Contra Costa County Family Engagement Unit. Over the past four and one-half years she has coordinated the Parent Partner Program by researching, developing, and implementing the model. She also provides training and direct supervision to the Parent Partner staff.

**Cheryl Barrett** is a full-time Parent Partner in Contra Costa County. She serves as a mentor, Parent leader and trainer. Ms. Barrett represents the parents' voice on committees, has helped train staff and community partners, and mentors families who are currently involved with the child welfare system.

**David Mason** is a Parent Partner in Contra Costa County. Having successfully navigated both the substance abuse and child welfare systems, he now works with families to give them hope and support as they overcome their individual challenges and work toward making good permanency decisions for their children.

---

### **Thunder Road**

Thunder Road's mission is to assist youth and their families in the challenges of recovering from the abuse of alcohol, drugs, and nicotine, as well as overcoming behavioral health conditions to support their growth as healthy, connected, and honorable members within our communities.

#### **Presenters**

**Marika Chin**, Admissions Team Leader, who has been working in the Admissions and Outreach Department for almost 5 years, will speak about Thunder Road's program and services. The Admissions Team is the first point of contact when families, social workers, probation officers, therapists, and other agencies call seeking information.

***The two teens who will speak*** were placed at Thunder Road by Alameda County and San Francisco County because their parents were unable to provide a stable home environment. With the lack of support from their families, the teens sought out drugs and risky behavior to fill voids. The teens will be speaking about their life experiences before entering Thunder Road and what their experiences are like during the program.

---

### **Wraparound: Is It Really Wraparound?**

This workshop will cover the principles, phases, and activities of the wraparound process used with families in the child welfare system. It will also highlight the importance of assessing fidelity to the model. MSW students will describe a research study in which they used an observation tool to rate team adherence to the principles of wraparound. They will also participate in a live demonstration of a wraparound team meeting.

#### **Presenter**

***Kathy Cox, L.C.S.W., Ph.D.***, is an Assistant Professor at California State University, Chico. She has many years of field experience working as a clinician, clinical supervisor, and administrator for agencies serving high-risk youth and families. Her research is focused primarily on family-focused, strength-based services, including wraparound.

---

Special thanks to  
the National Association of Social Workers (NASW),  
California Chapter for its generous contribution  
to this conference. NASW has worked closely with CalSWEC  
since its founding and continues as  
an important member of the CalSWEC consortium.

***Exhibitors***

National Association of Social Workers-CA  
CASA: Court Appointed Special Advocates

***Vendors***

Valerie Brown-Troutt Designs

***Sponsors***

National Association of Social Workers—California  
CASA (Court Appointed Special Advocates)

# First Floor Plan

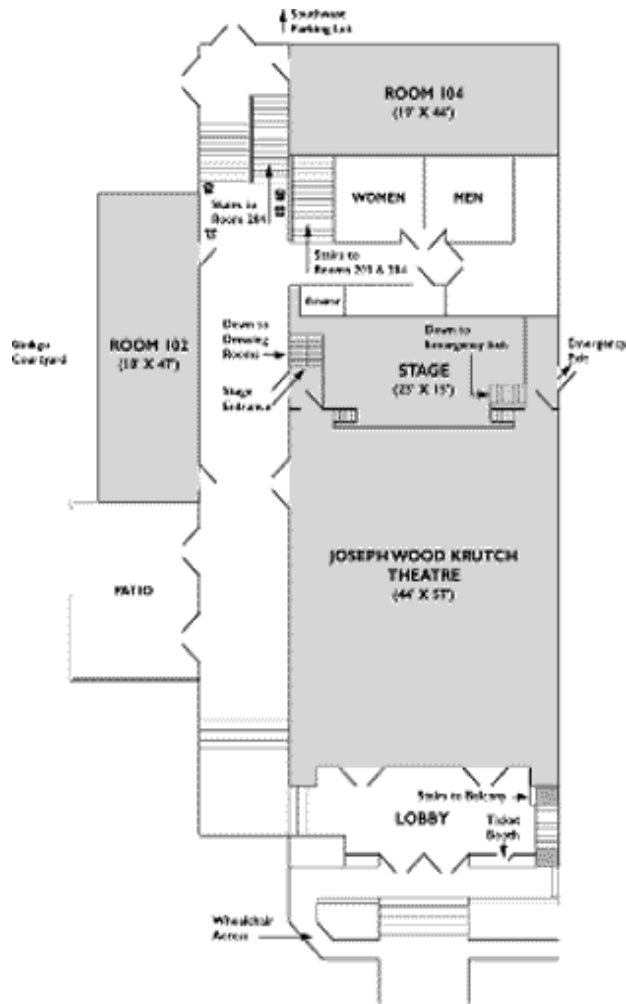

## Second Floor Plan

